

ROLLER SERVICE – YOUR DATA FOR INITIAL ENTRY

Company:	Address:
Contact person:	Postcode/city:
INOMETA customer No.:	Phone number:
VAT ID:	

ACTUAL SITUATION

Was the roller built by INOMETA or has it already been serviced by INOMETA?

Yes Please complete and continue with the "Application" section.

Old order number:	Last order number:
<small>E.g. 999xxxxx or 56.xxxx</small>	
INOMETA item number:	Own roller ID number:

No Please complete the following fields:

Own roller ID number:	
Drawing available?	Yes (please send drawing as an attachment) No (please complete the following fields)

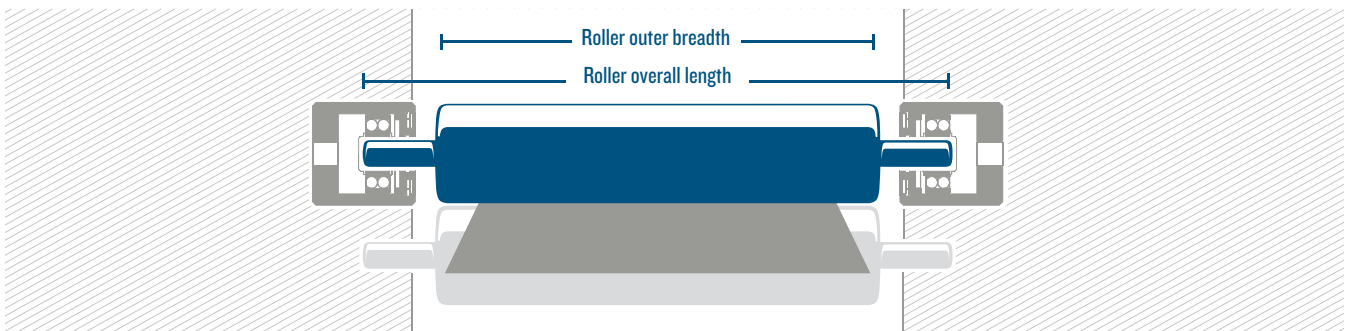

Roller function (e.g. draw roller, fold roller, cutter roller):

Length of roller outer breadth:	mm	Roller overall length:	mm
Roller diameter:	mm	Machine speed:	m/min
Roller coating:	Rubber PUR Thermal Chrome	Composite coating	Coating thickness: mm
Roller weight:	kg		
Roller body material:	Steel Aluminium CFRP Stainless steel Other:		
Journal material:	Steel Stainless steel Other:		
Please add at least 3 photos of the actual condition of the roller:	Left end face	Right end face	Roller surface

Roller type:

Roller with shaft



Roller with stub shaft

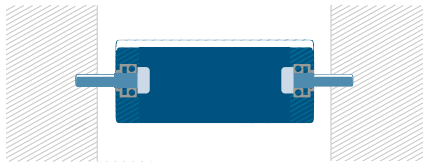

Roller with fixed journal extension

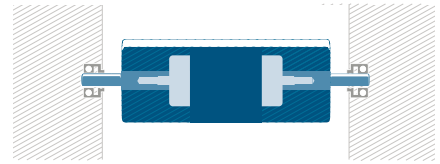

Roller body

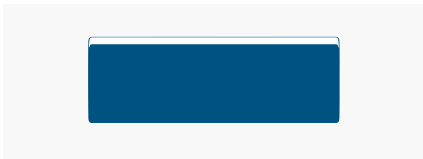

Surface (only if different to flat, blank and cylindrical surface):

Spiral grooved

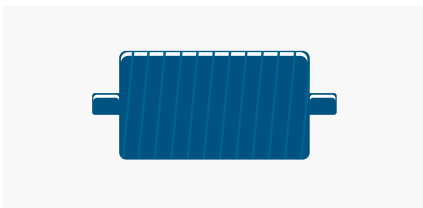

Form:

Concave

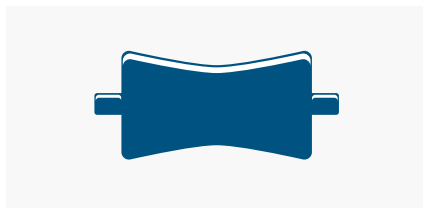

Form:

Convex

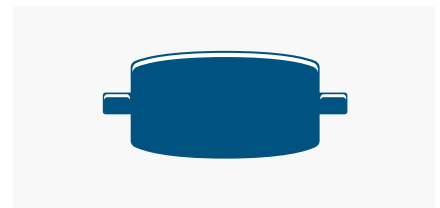

Form:

Grooved

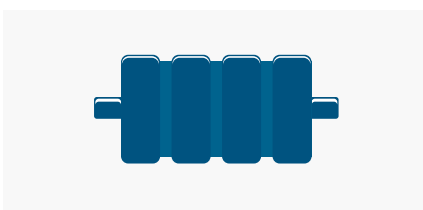

Form:

Other (please send a sketch):

APPLICATION

Ambient temperature: _____ °C

Ambient conditions (e.g. steam, moisture, hazardous area etc): _____

SERVICE LEVELS

	Service level 1	Service level 2	Service level 3
Incoming goods check	✓	✓	✓
Remove existing surface	-	✓	✓
Bearing seat temperature	-	-	✓
Coating	✓	✓	✓
Assembly	✓	✓	✓
Balancing (in 2 or 3 planes)	Chargeable additional option		
Install new bearings	Chargeable additional option		
Report	Chargeable additional option		

The rollers are to be delivered disassembled. Otherwise, we reserve the right to charge for any disassembly costs incurred.

Diameter tolerance:	INOMETA standard (+/- 0.1 mm)	Other, the tolerance is:	mm
Concentricity tolerance:	INOMETA standard (0.035 mm/m)	Other, the tolerance is:	mm/m
Cylindricity tolerance:	INOMETA standard (0.035 mm/m)	Other, the tolerance is:	mm/m

DESIRED ROLLER COATING AND SURFACE

Coating: PROTEK® composite PROTEK® anti-stick PROTEK® ceramics PROTEK® carbide Other:

If known, PROTEK® coating:

Requirements on surface properties and possibly surface roughness:

Establish contact regarding coating advice: Yes No

SCHEDULING AND LOGISTICS

Desired completion date:

Collection desired: Yes No Box dimensions: h= cm w= cm l= cm weight: kg

Please ensure items are delivered punctually. Storage costs may be incurred for an earlier delivery than the delivery date scheduled in our order confirmation.

ADDITIONAL INFORMATION

CHECKLIST: IS ALL INFORMATION COMPLETE?

- Enquiry form completed ✓
- Engineered roller drawing attached ✓
- Drawing/photos of journal and bearing attached ✓
- Roller service schedule specified ✓
- Processing specifications attached ✓



service@inometa.de ✓

[SEND NOW BY EMAIL >](#)